

Other models in this range:
 MAR 56 - MAR 76 - MAR 106
 MAR 126 - MAR 206
 Split versions:
 MAR 78 - MAR 128 - MAR 208
 MAR 308

Scale Ice Maker Units up to 2450 Kg



ABS Ice Chute Cover: sold separately.



Gear box protection (hall effect)



Easy to remove water sump



Pulleys & belt system allows to modify ice thickness

Remote Condenser



MAR 306+UBH2250 (sold separately)



MAR 306+B3200 (sold separately)



MAR 306+B4600 (sold separately)



MAR 306+ITS2250 (sold separately)



MAR 306+ITS3250 (sold separately)



Features

- Modular scale ice machine, production up to 2450 Kg in 24h (@ 1 mm. ice thickness)
- Scale ice machine, in "compact system" version; built-in unit
- Storage bin not supplied, to be purchased separately
- AISI304 Stainless steel evaporator and ice scraper blade
- Redesigned evaporator compartment end-walls
- Foodgrade ABS plastic water sump tray, easy remove for cleaning and sanitising
- Electromechanical control panel
- Electrical protections, rotation speed & reverse phase controls
- Low- water sensor protection
- Hermetic compressor
- Choice of air or water cooled condenser
- Drive motor / gear reducer with V-Belt drive
- Storage bin thermostatic ice level sensor
- Stainless steel panels in scotch-brite finish, with rounded corners, easy to remove for maintenance

Accessories & Optional Features (to be specified upon order):

- Ice spout cover (COVERMARL0000)
- Ice chute extension 90cm (KICMAREXT0001)
- Double ice chute 65cm (KICMARDOUBL02)
- Infrared ice sensor (replaces the thermostatic ice level control) ICE SENSOR0003
- UV lamp water sanitising system for bacterial control (KITUVLAMPMAR1)
- ON/OFF manual switch, with daily timer (KITTIMER0001)
- ON/OFF manual switch, with weekly programmable timer (KITTIMERSET01)

MAR 306 Technologies



	 +C° -C°	 24h THICK ICE		 THIN ICE		 NOMINAL ONLY		 [WxDxH mm] 1326x853x1125
		 2 mm [kg] [lbs]	 1 mm [kg] [lbs]	 0,5 mm [kg] [lbs]				
MAR306 WS		2200	4850	2450	5400	3190	7033	[WxDxH inches] 52 3/16 x 33 9/16 x 44 5/16
MAR306 WS-SW		2200	4850	2450	5400	3190	7033	
MAR306 ASR		2050	4520	2350	5180	2973	6554	 [vHz/ph] 400/50/3N R 404 A



Humidity 2%

Ice scales are the coldest form of ice. Formed at -6° to -12°Celsius, they are very dry, containing less than 2% residual water. Scales look like fragments of glass, have an irregular shape and a thickness that can be adjusted at 1 or 2 mm.

This product qualifies for the following listings:



2 Years Warranty

Subject to certain limitations and exclusions

Certified ISO 9001:2000

www.scotsman-ice.it
www.scotsman-ice.com
www.scotsman-ice-on-tablet.com

Models and specifications are subject to change without notice.

Other models in this range:
 MAR 56 - MAR 76 - MAR 106
 MAR 126 - MAR 206
 Split versions:
 MAR 78 - MAR 128 - MAR 208
 MAR 308

Scale Ice Maker Units up to 2450 Kg

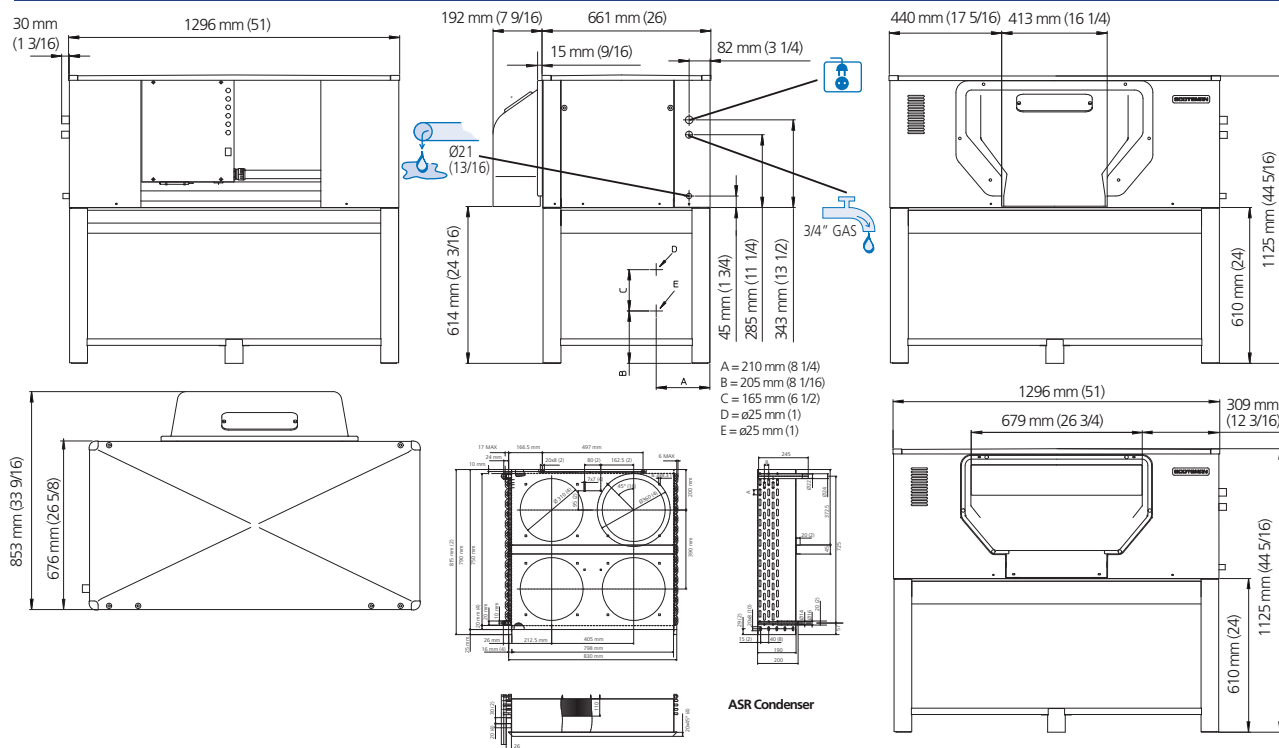

MAR 306 ASR

°C / °F	50° / 10°	60° / 15°	70° / 21°	90° / 32°	
10°	2050	2000	1950	1900	kg
50°	4520	4410	4300	4190	lbs
21°	1980	1940	1900	1860	kg
70°	4366	4278	4190	4101	lbs
32°	1780	1740	1700	1660	kg
90°	3925	3837	3749	3660	lbs
38°	1650	1610	1570	1530	kg
100	3638	3550	3462	3374	lbs



WITH THICK ICE SETTINGS

MAR 306 WS-SW

°C / °F	50° / 10°	60° / 15°	70° / 21°	90° / 32°	
10°	2200	2100	2000	1800	kg
50°	4850	4631	4410	3969	lbs



WITH THICK ICE SETTINGS



Minimum

10°C (50°F)

5°C (41°F)

-10%

1 BAR
14 psi



Maximum

40°C (104°F)

35°C (95°F)

+10%

5 BAR
70 psi

	Icon	(T cond.+45°C - T evap.-25°C) ASERCOM Conditions	[W]	[Btu/h]	[Ø mm ²] [AWG]	[W]	FUSE	[kWh] - 100 Kg	[l/h]	[gal/h]	[kg] [lbs]	[kg] [lbs]
MAR 306 WS	Water/Water		13300	45380	5x4 AWG11	9000	32 A	10,8	2000	528	390 858	413 909
MAR 306 WS-SW*	Water/Water		13300	45380	5x4 AWG11	9000	32 A	10,8	2000	528	390 858	413 909
MAR 306 ASR	Air		13300	45380	5x4 AWG11	10000	32 A	14,1	70,8	18,7	360 792	383 843

*SW sea water cooling only